

## The ClassVR Headset Interface

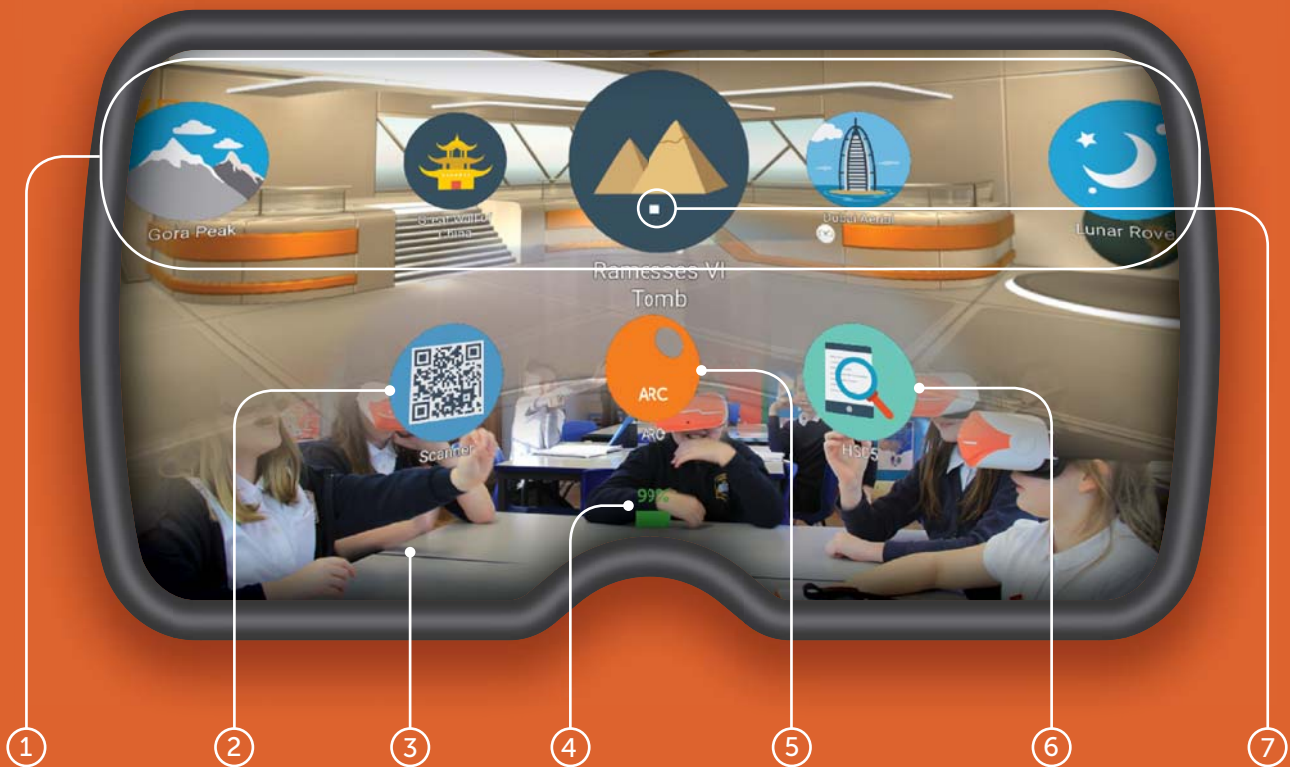

### ① VR Experiences

Immerse your class in a huge variety of Virtual Reality experiences, either from the provided collections or create your own using the ClassVR Portal.

### ② QR Code Scanner

Used to quickly switch between collections of VR experiences.

### ③ Augmented View

Keep students safe and aware of their environment. The front facing camera projects the immediate surroundings into the headset, in real-time.

### ④ Battery Level

The colour will turn red when battery is low.

### ⑤ ARC App

Load up preconfigured Augmented Reality activities.

### ⑥ Device Information

Quickly display information about the headset.

### ⑦ White dot (reticle)

Treat this dot as your select tool to highlight items you wish to open.

## How to turn your headset on

To turn your ClassVR headset on, simply press and hold the power button on the left side of the headset for five seconds.



## Gesture Controls

### Scrolling and selecting a menu item

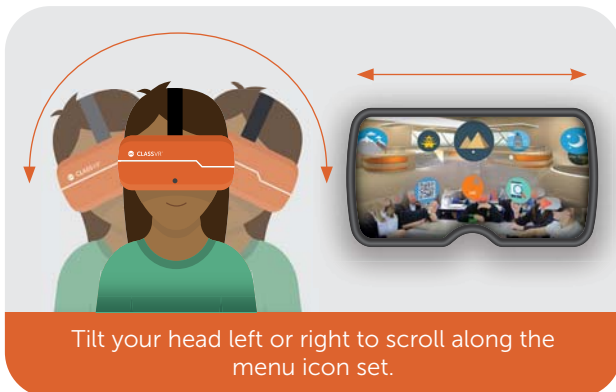

Tilt your head left or right to scroll along the menu icon set.

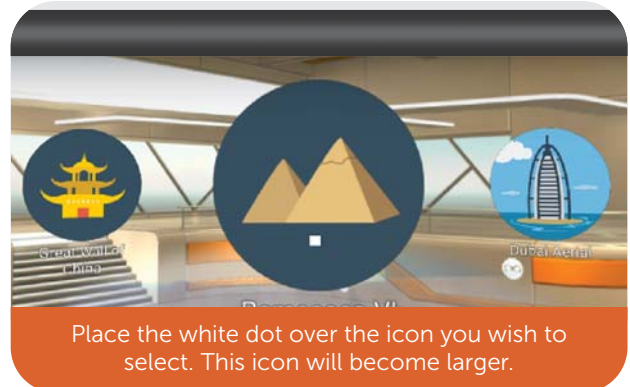

Place the white dot over the icon you wish to select. This icon will become larger.

### Opening a menu item

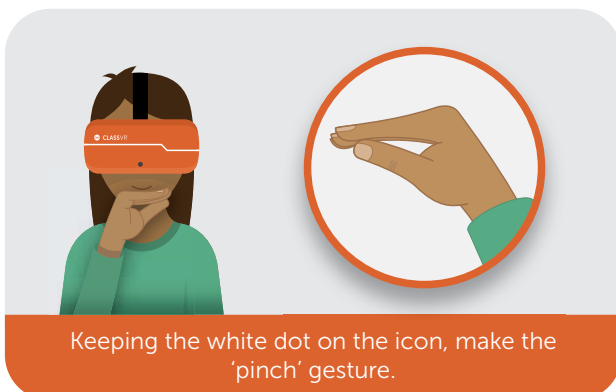

Keeping the white dot on the icon, make the 'pinch' gesture.

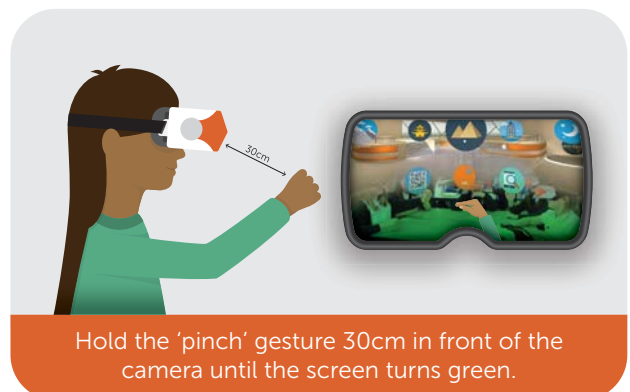

Hold the 'pinch' gesture 30cm in front of the camera until the screen turns green.

### How to return to the home menu

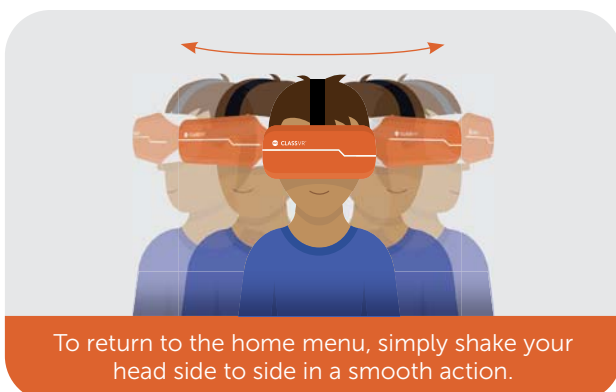

To return to the home menu, simply shake your head side to side in a smooth action.

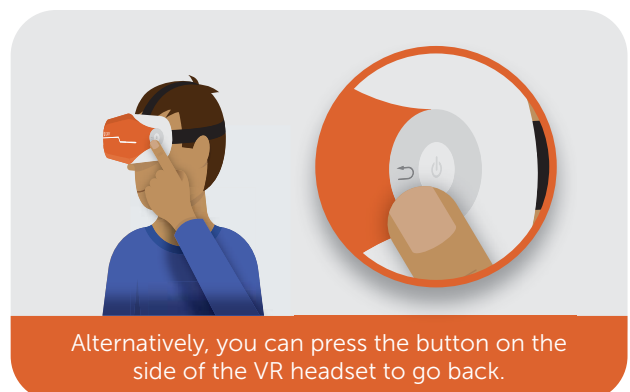

Alternatively, you can press the button on the side of the VR headset to go back.

## Loading Virtual Reality Collections linked to lesson planning

### How to allow students to browse through relevant VR experiences

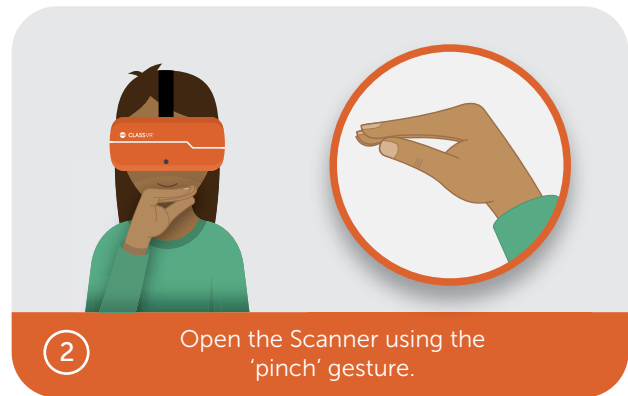

## Accessing Augmented Reality content

### How to use the AR worksheets in class

